

MÖTTUKID
19.11.2012
Grafur Pásson

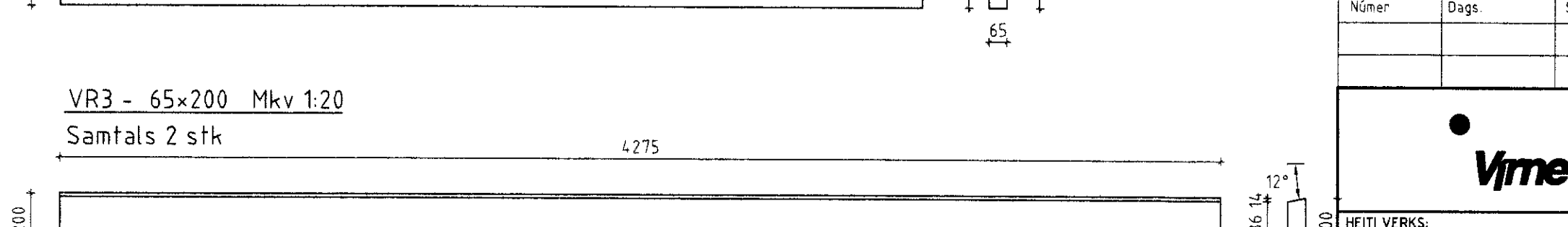
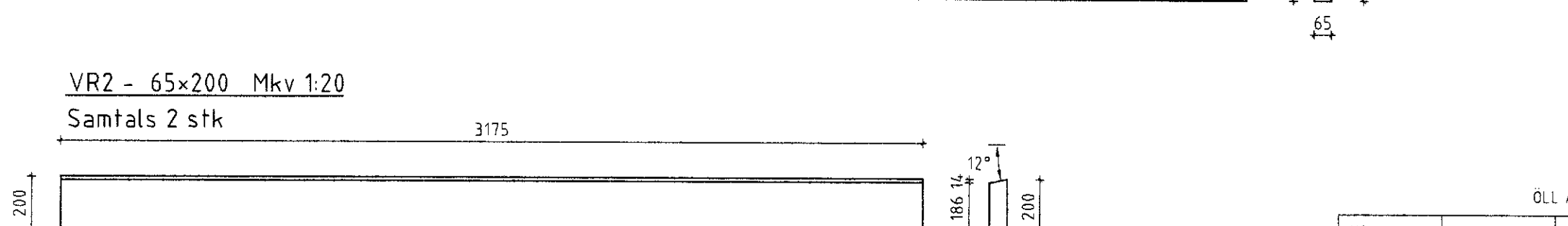
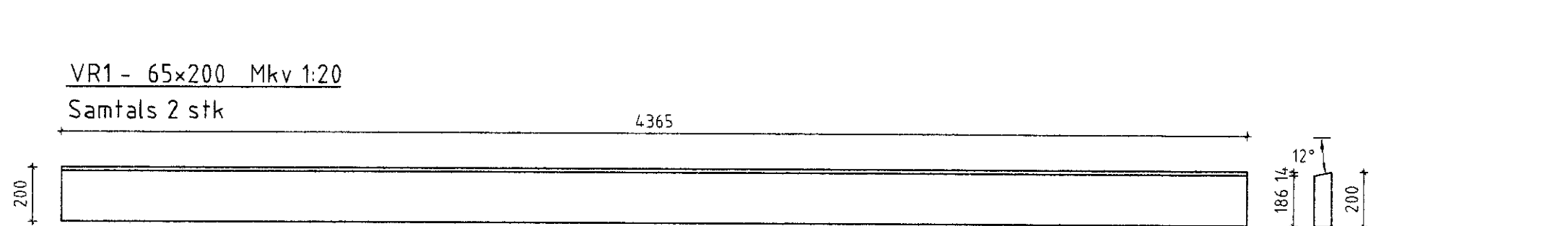
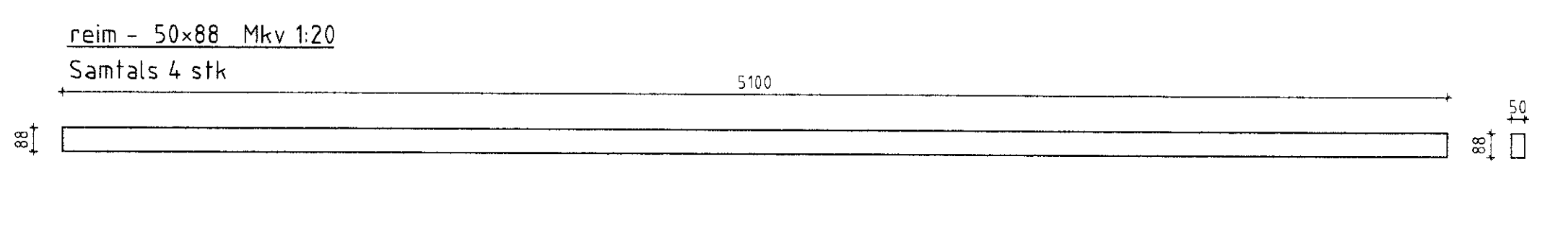
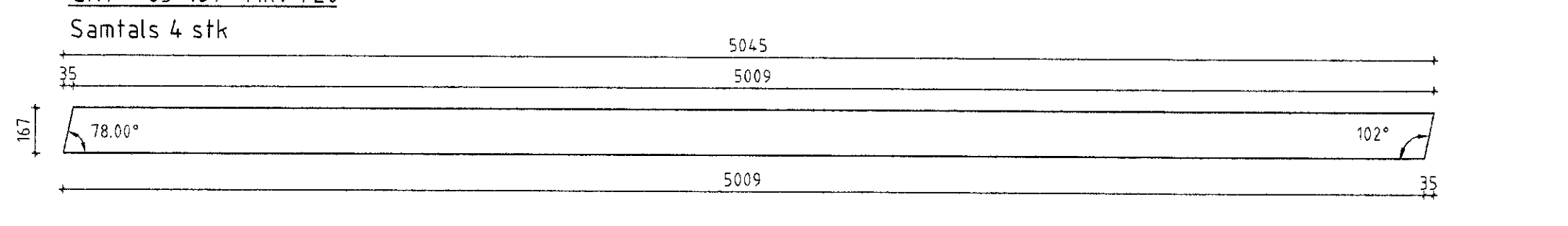
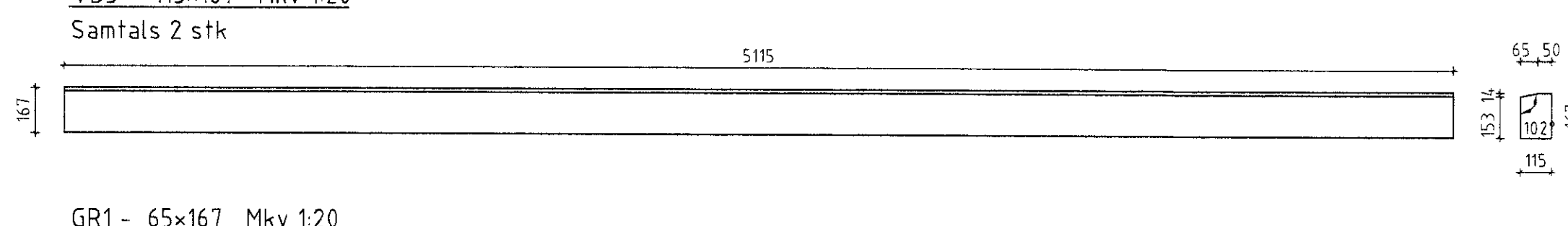
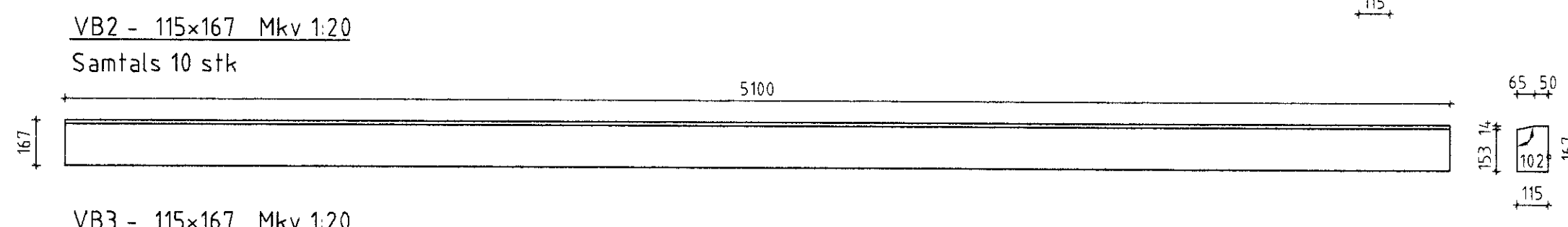
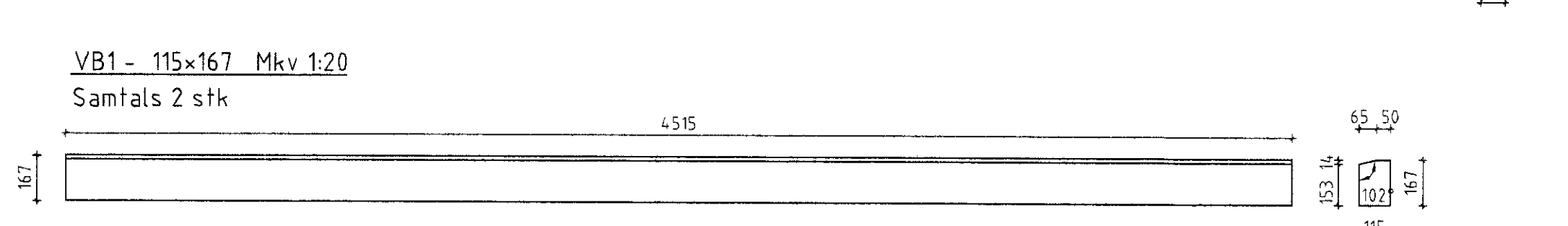
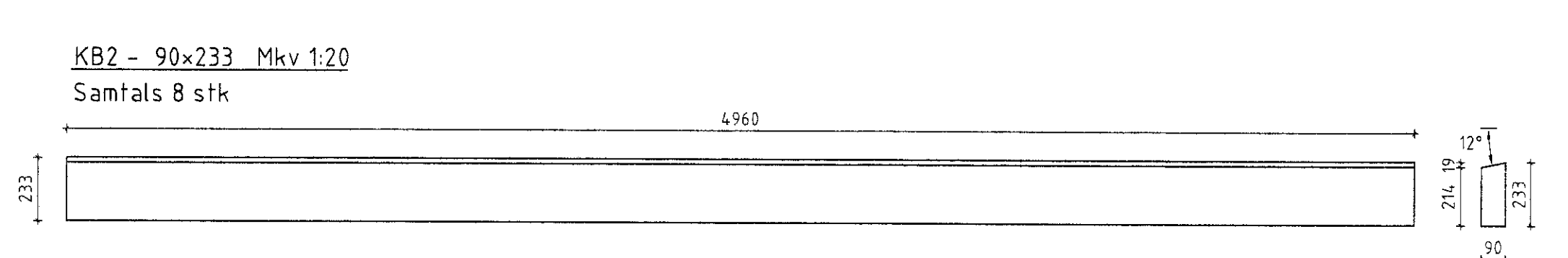
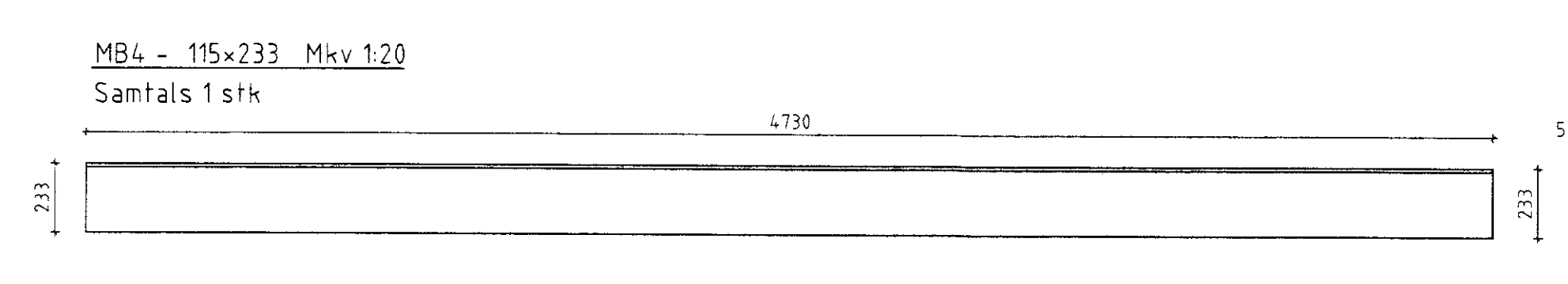
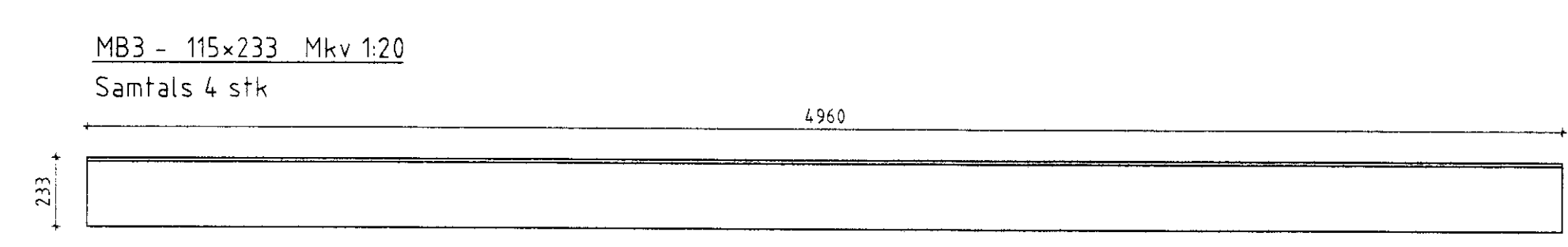
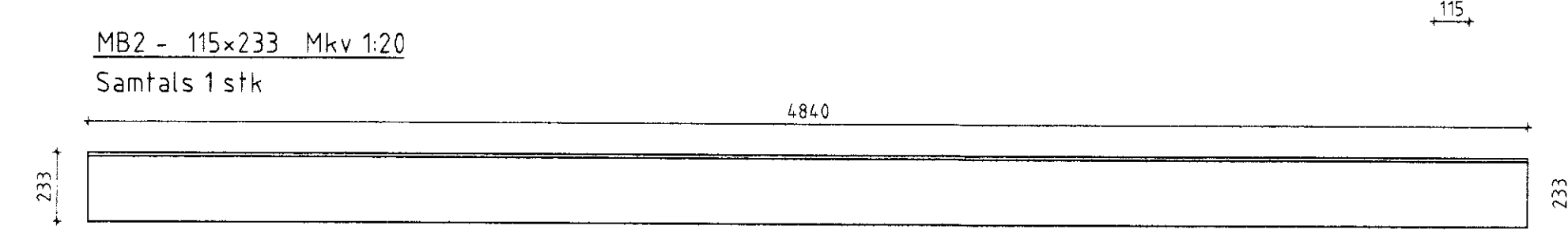
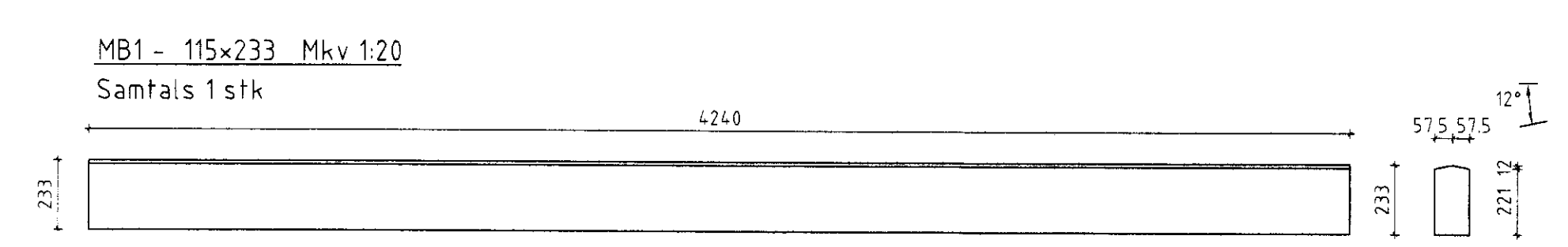
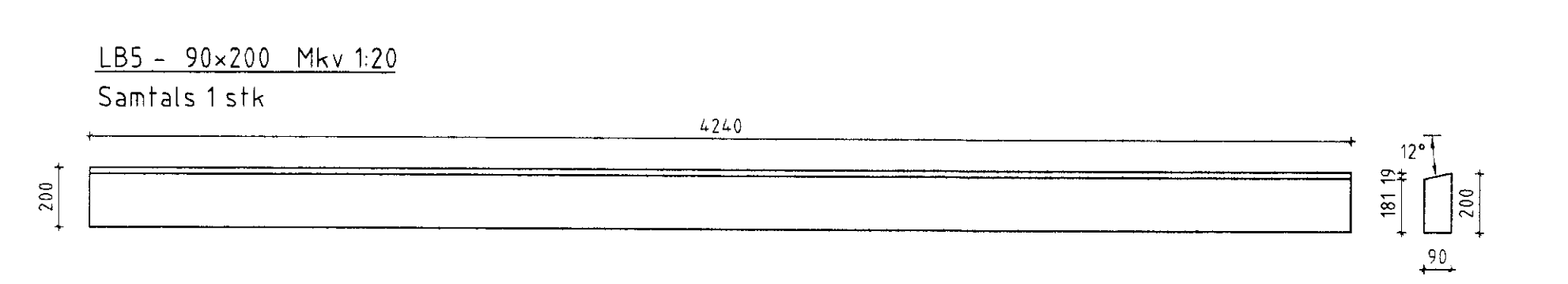
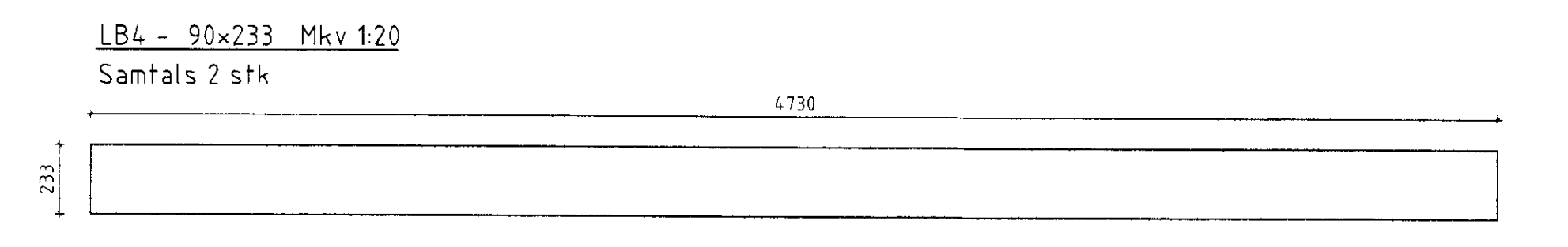
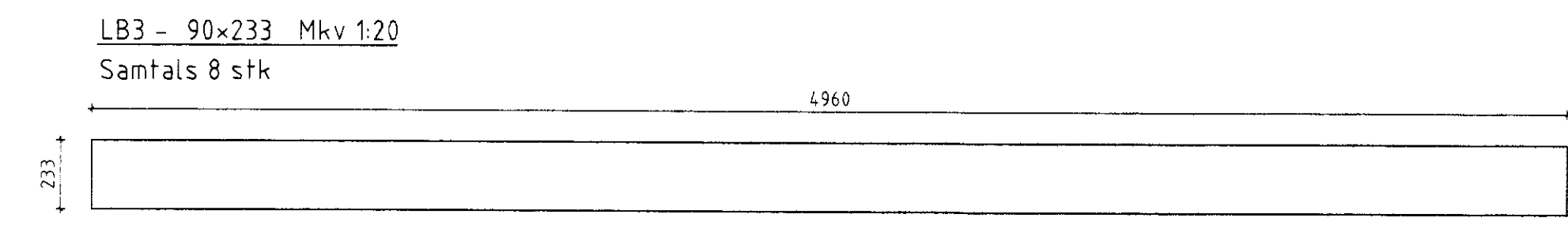
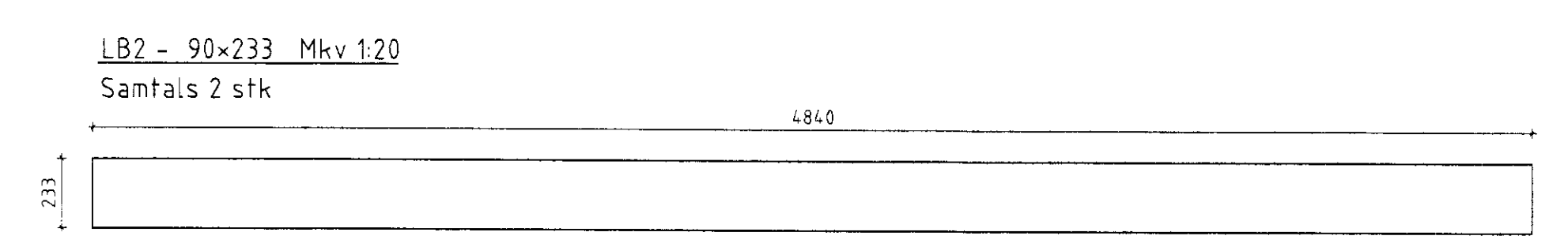
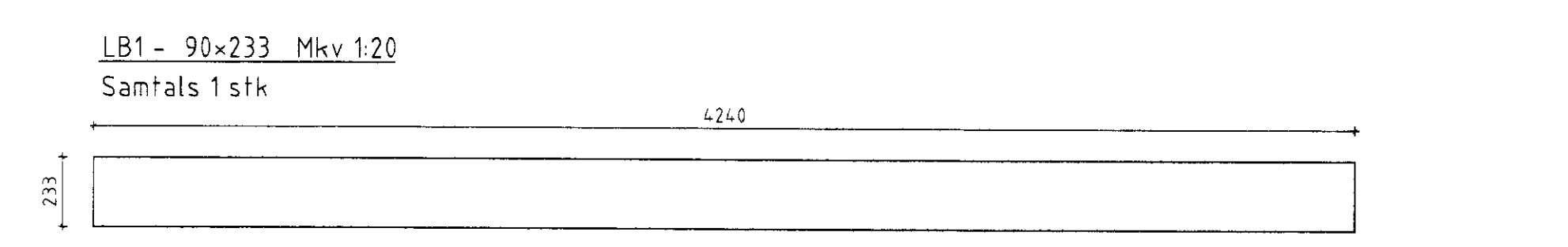
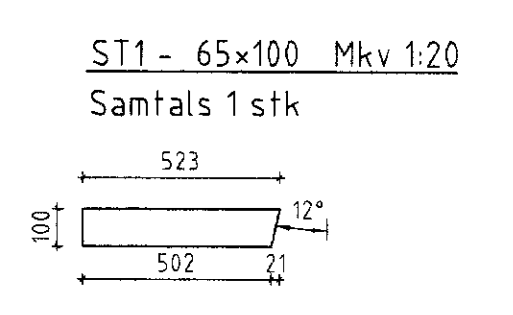
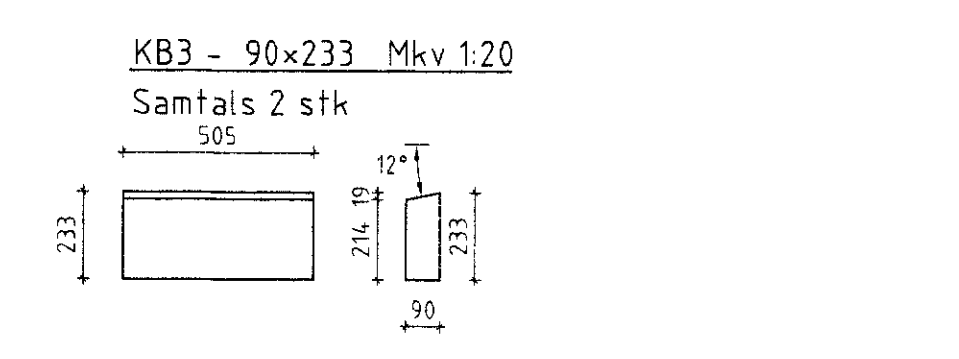
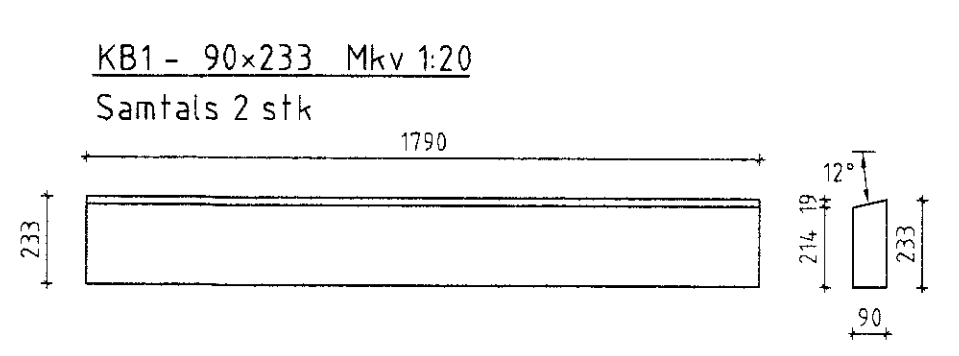
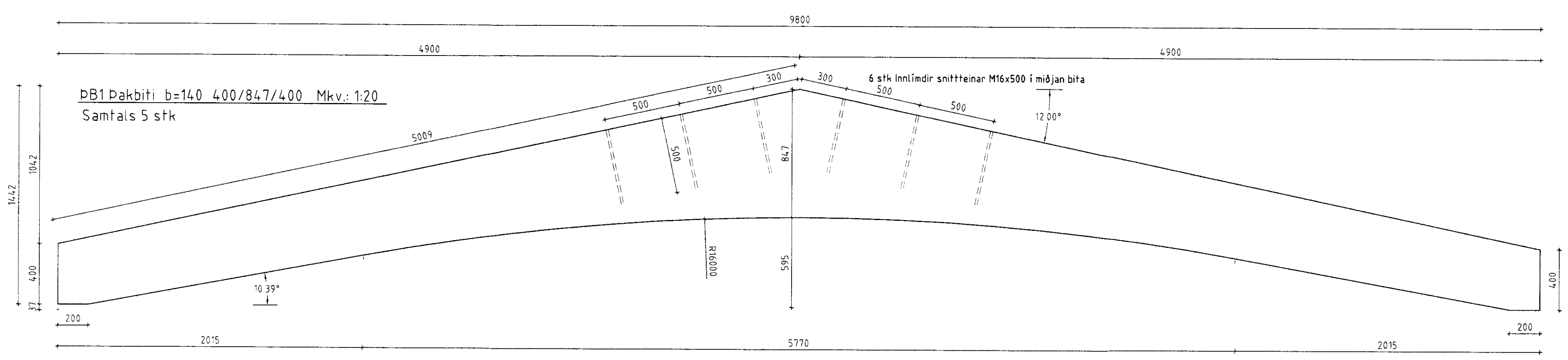

ÖLL AFNOT OG AFRITUN TEIKNINGAR AD HLUTA EDA Í HEILD ER HÁÐ SKRIFLEGU LEYFI LÍMTRÉ VÍRNET EHF.

Númer	Dags	Skýring breytingar	Br. af
		MKV: 1:20 DAGS: 25.11.2011 VERKNR: DL11 032 ÚTGÁFA NR. 1	NR. TEIKNINGAR 381
HEITI VERKS: Túnberg Hrunamannahreppi		NAFN HÖNNUÐAR Bjarni Ingibergsson byggingatæknifræðingur B.Sc. kt. 030861-2729	DAGS. ÁRITUNAR 29.11.2012
HEITI TEIKNINGAR Hesthús Límtré framleiðsluteikningar		ÁRITUN HÖNNUÐAR 	DAGS. ÁRITUNAR 29.11.2012