

GRUNNMYND KJALLARA 1:50

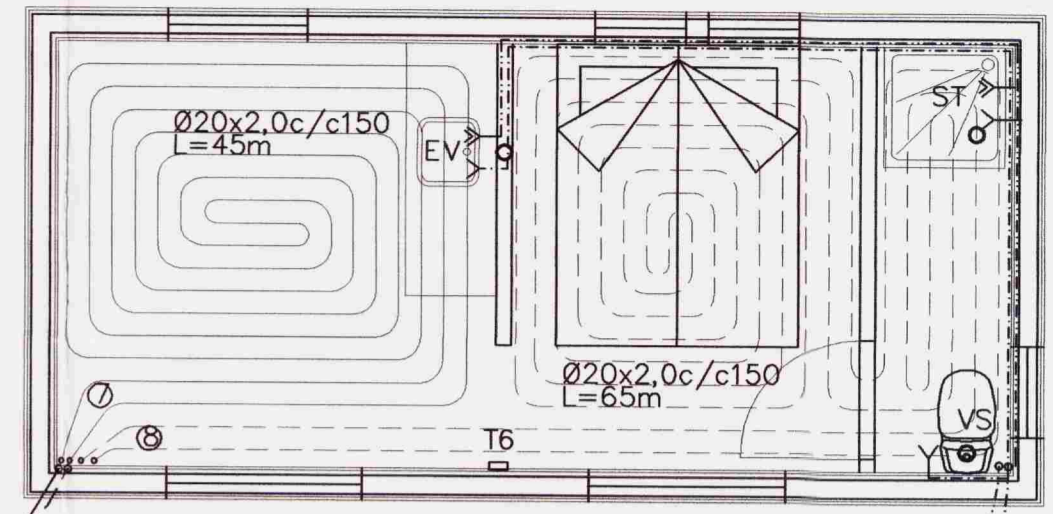

GRUNNMYND 1:50

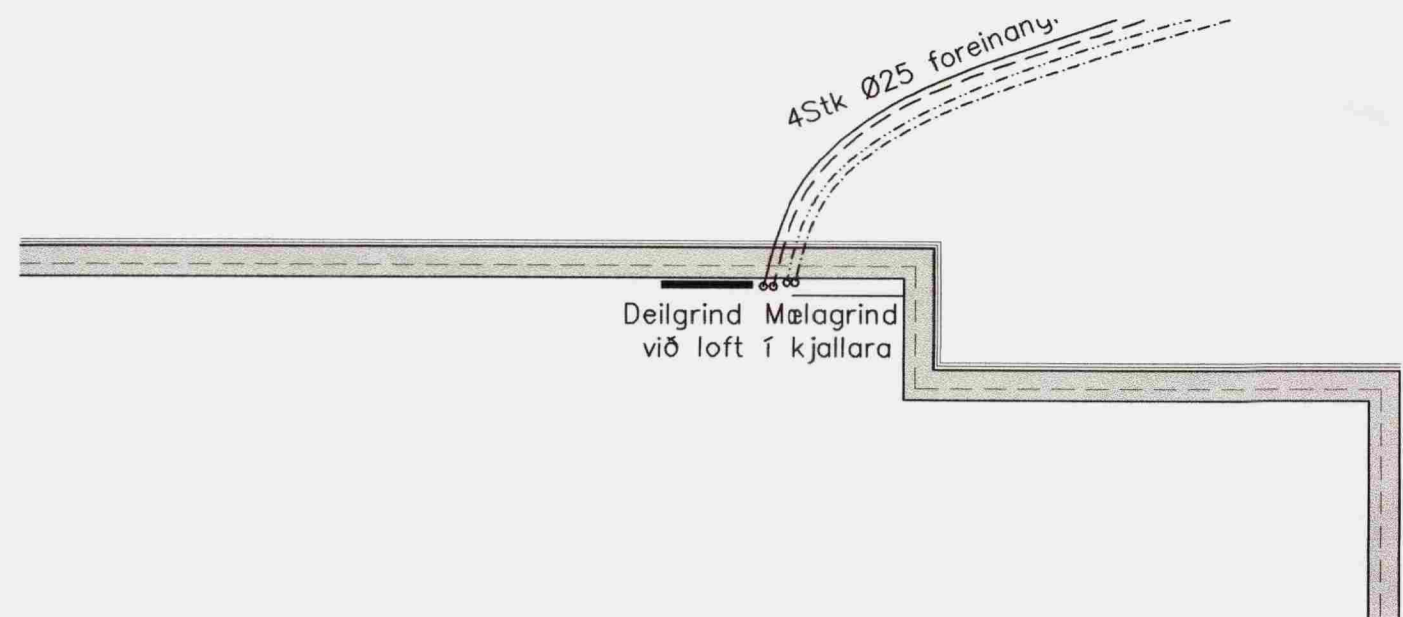
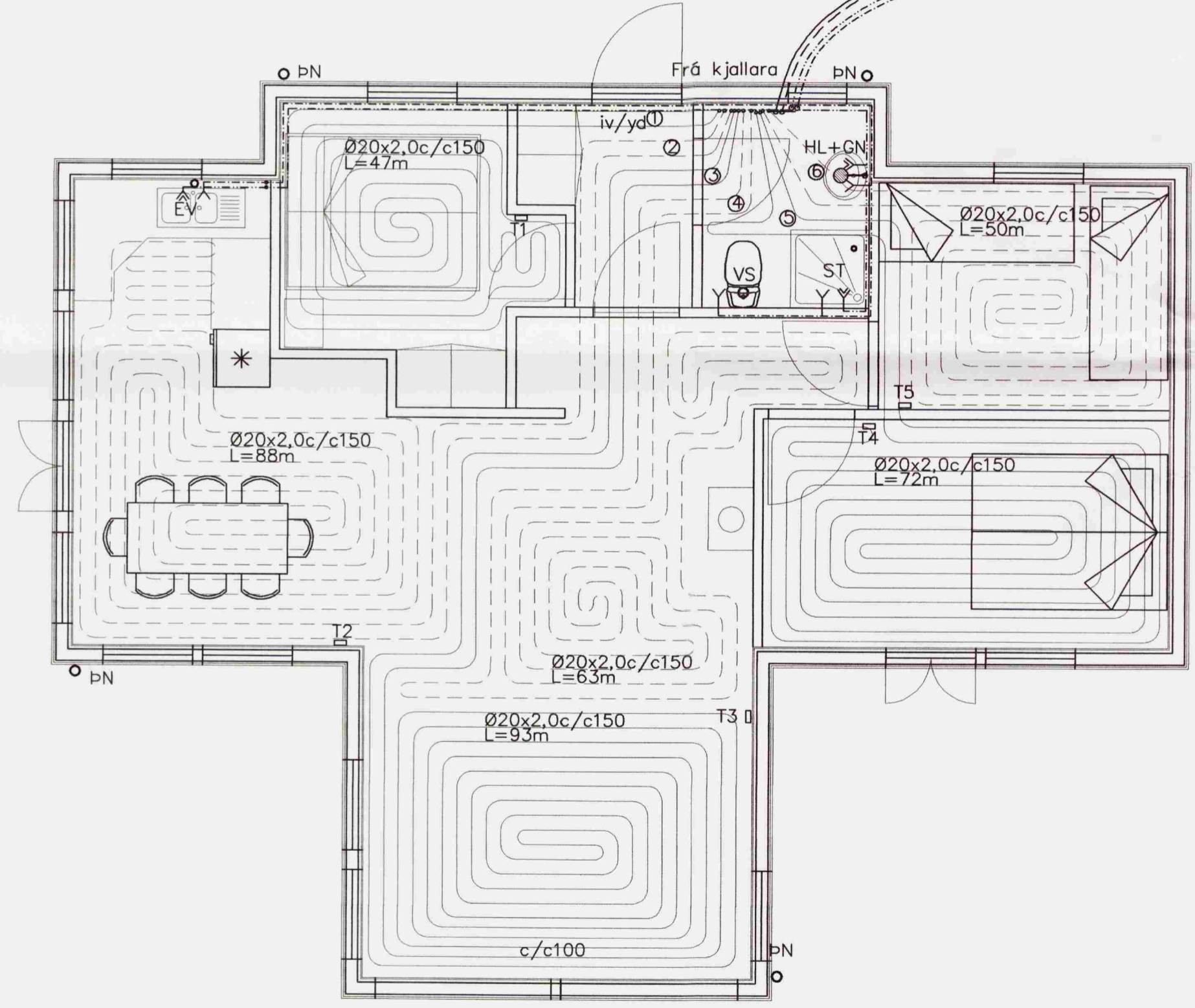

4Stk Ø25 foreinangruð rör

SUMARHÚS LANDI HESTS 91							Afköst gólfhita		
HERBERGI:	Slaufa númer	Lengdi slaufu m	Millibil rör m	Hitastig Herbergi °C	Meðal hiti inn 50 °C út 30 °C	Varmagjafi slaufa m ²	Raun flöður Hitaður upp m ²	Afköst Slaufu Wott/klst/heid	
1	Herbergi	1	47	0,150	20	40	83	7,05	585
2	Eldhús	2	83	0,150	20	40	93	14,55	1.353
4	Stofa	4	93	0,150	20	40	83	15,00	1.245
5	Gangur / stofa	5	64	0,150	20	40	83	7,05	585
6	Herbergi	6	50	0,150	20	40	83	7,50	623
	Herbergi	6	72	0,150	20	40	83	10,80	896
	Gestahús	7	45	0,150	20	40	83	6,75	560
	Gestahús	8	65	0,150	20	40	83	9,75	809
Samtals							523	78	6.657

Breytingar			SUMARHÚS Í LANDI HESTS 91	
Nr.	Dags.	Nafn		
			Verkfræðistofa Þráinn & Benedikt Laugavegi 17B, 105 Rvk Sími: 553 1770, 568 7775, Fax: 568-7701 Netfang: verkfraedistofa@verkfraedistofa.is	
			H BS T HS S M 1:50 Nr. P101	
			Hiti, vatn, og frárennsli Dags. jan '08 080149-3609 	