

MÓTTÉKIÐ

01 JUNÍ 2011

Gudni Þórisson
Byggingafræðingur / Umskiptingamyndingun

DAGS:	NR:	BREYTINGAR:	SAMB.

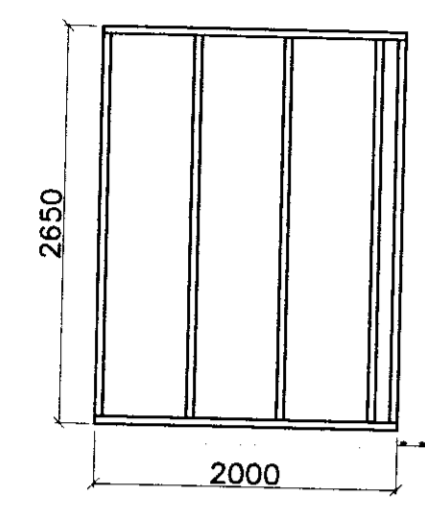

Grind 05

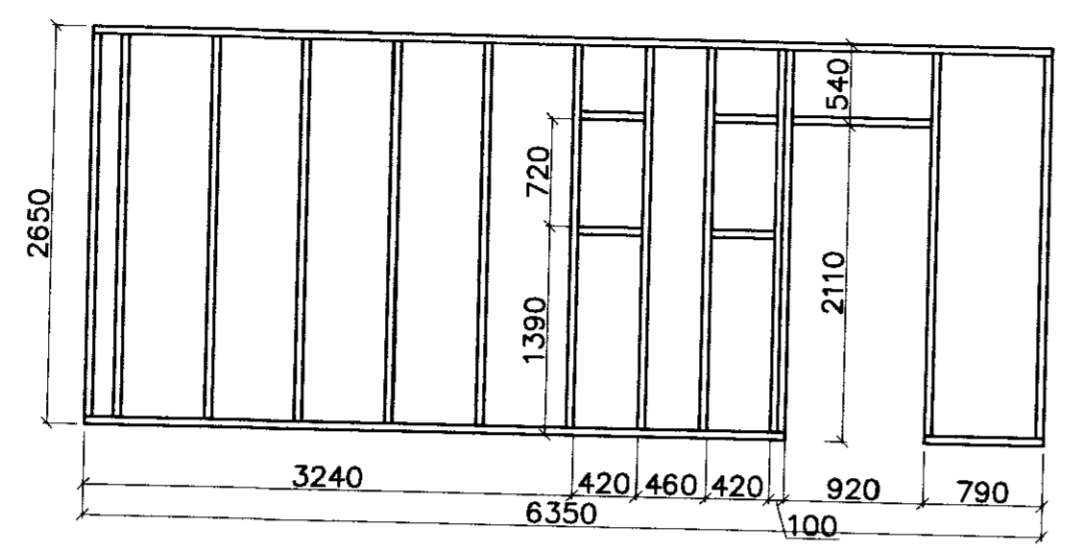

Grind 04

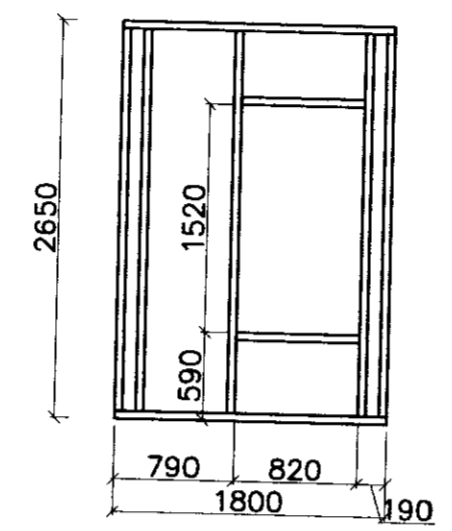

Grind 08

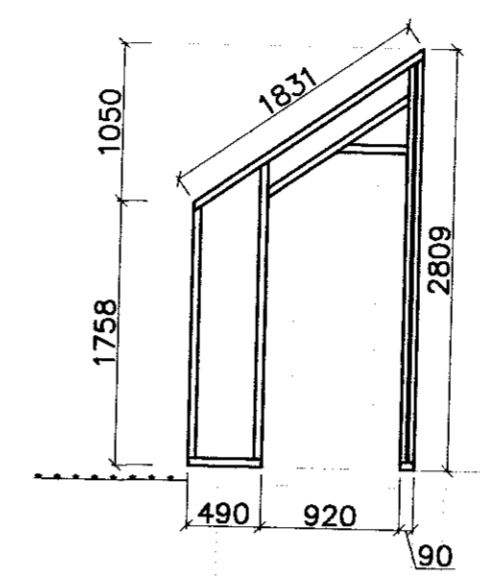

Grind 03

BMF-90 vinklar beggja megin.
Negling: 2x6 Stk. K40/60 í sperru & 2x8 Stk. K40/60 í límtré.

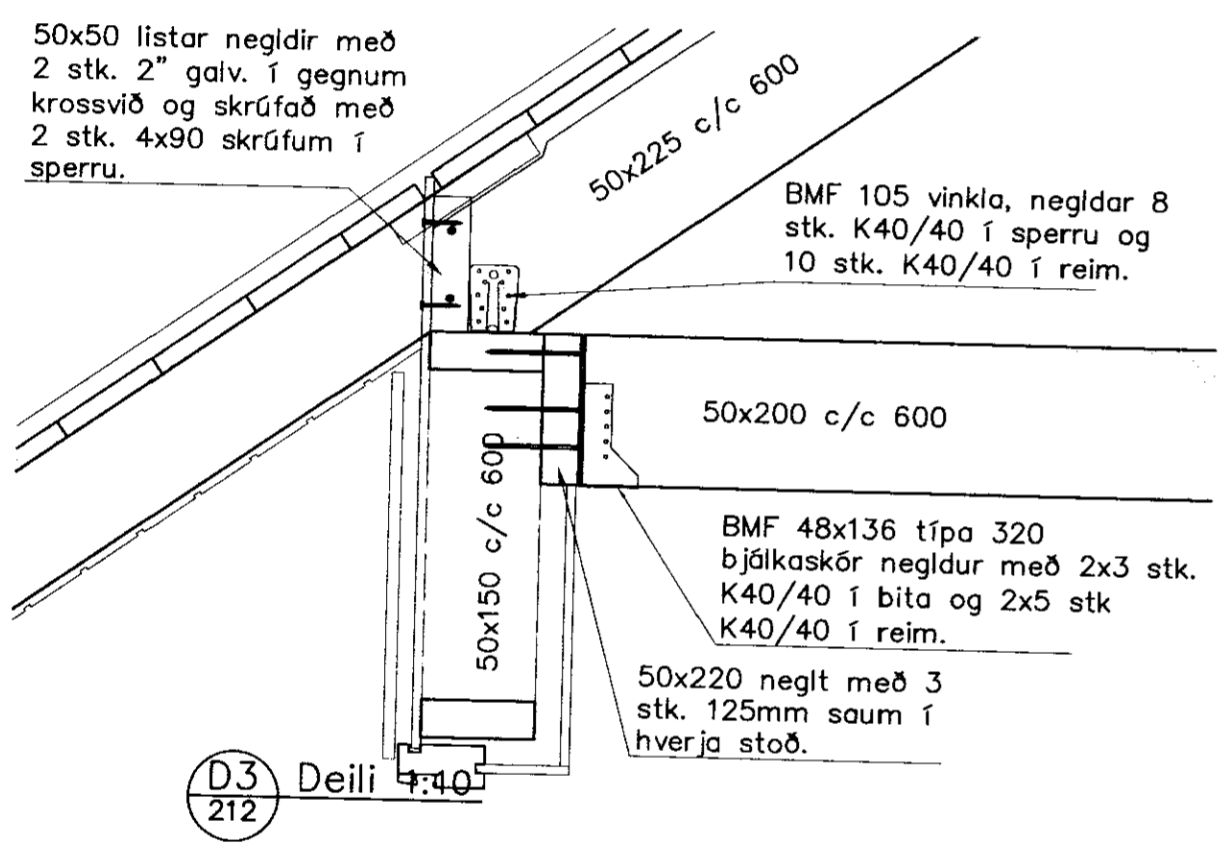

D3 Deili 1:40

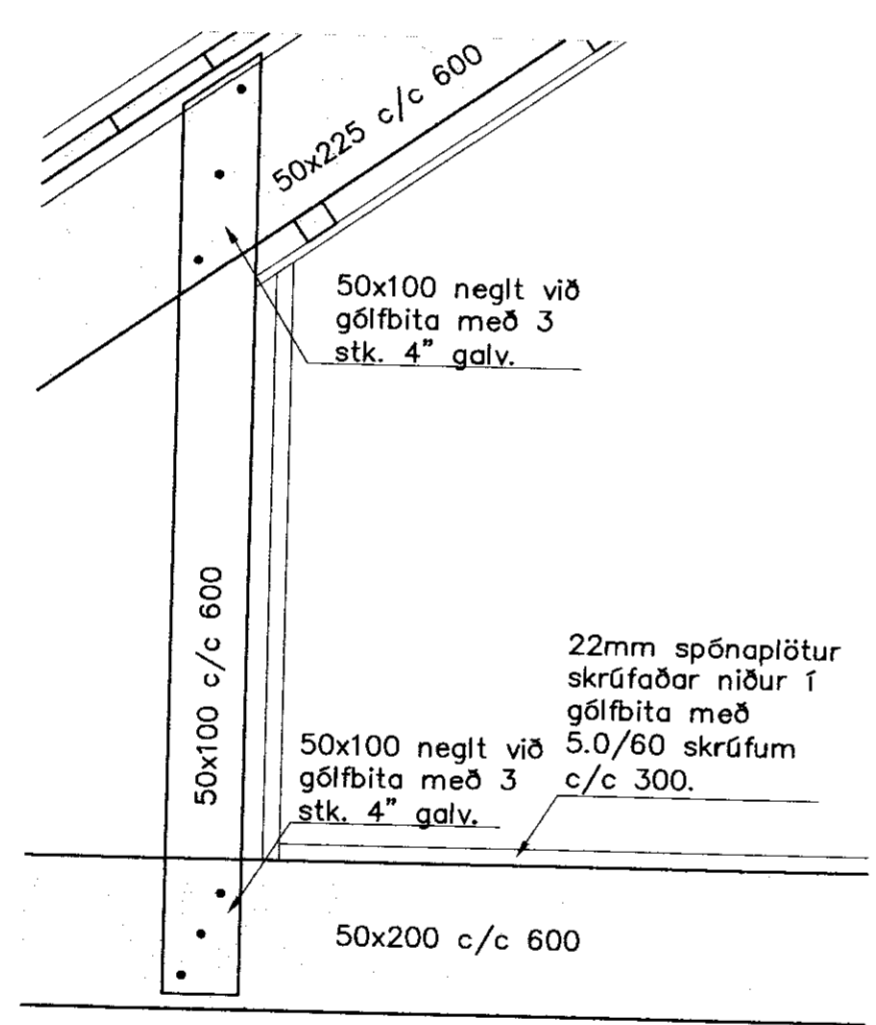

D4 Deili 1:10

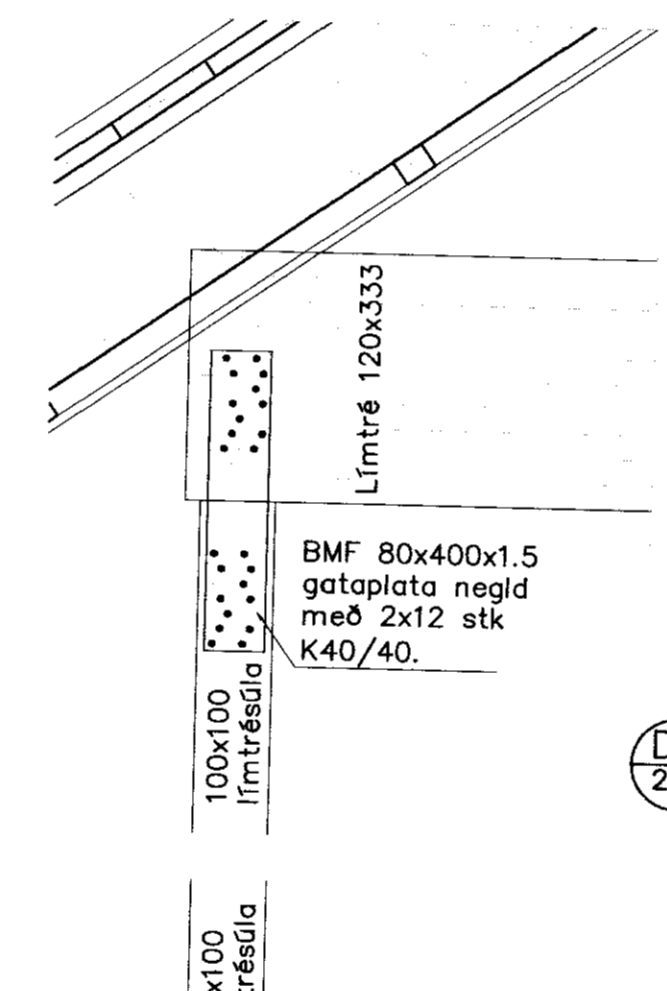

D Sníð 1:10

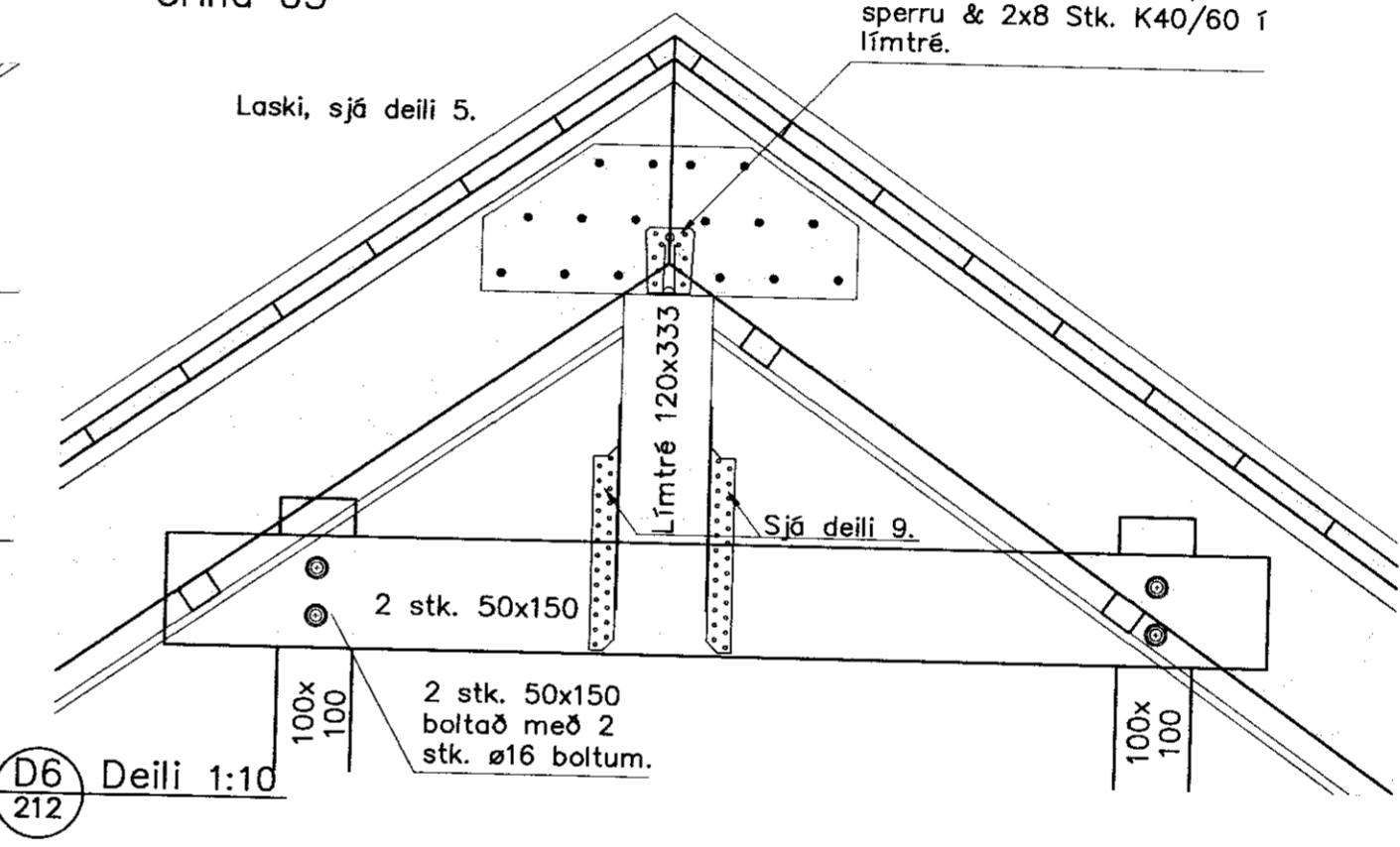

D6 Deili 1:10

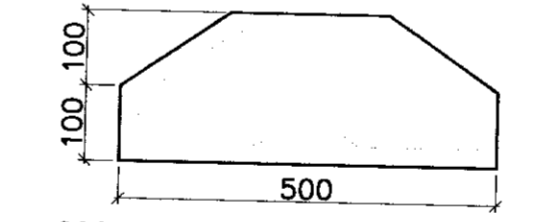

200x500 krossviðarlaski, þykkt = 12mm, neglt í urethanlím. Negling 2x8 stk. 75mm saumur.

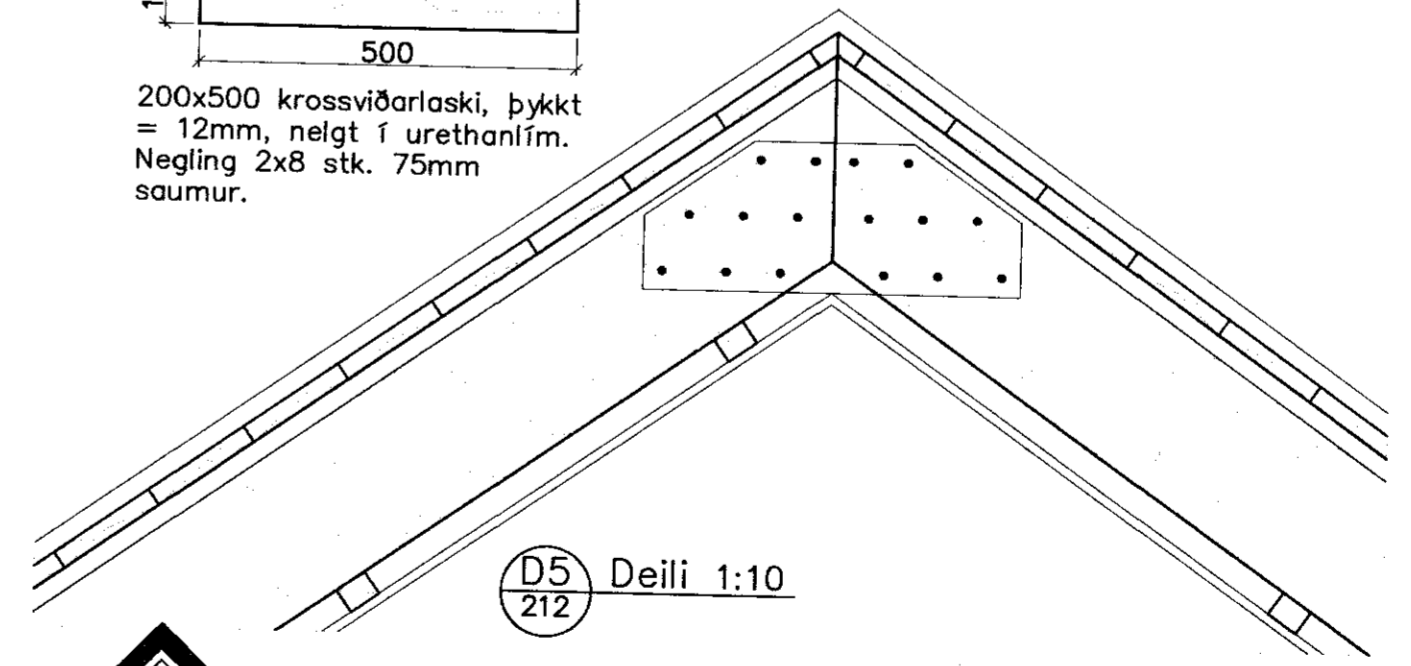

D5 Deili 1:10

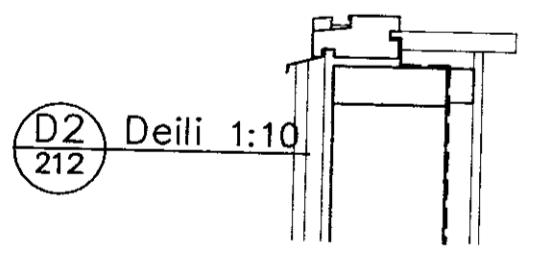

D2 Deili 1:10

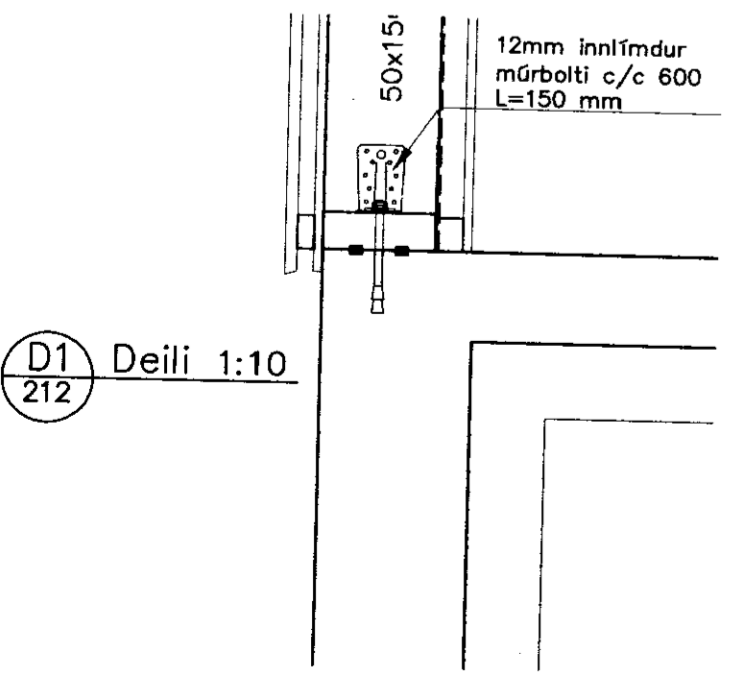

D1 Deili 1:10

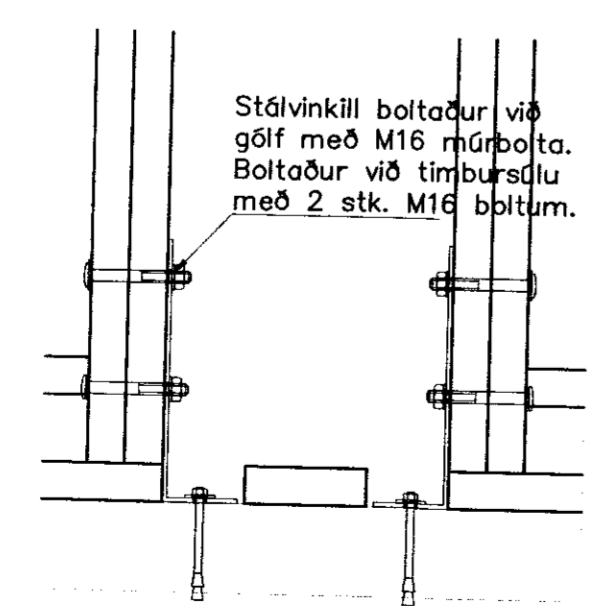

D10 Deili 1:10

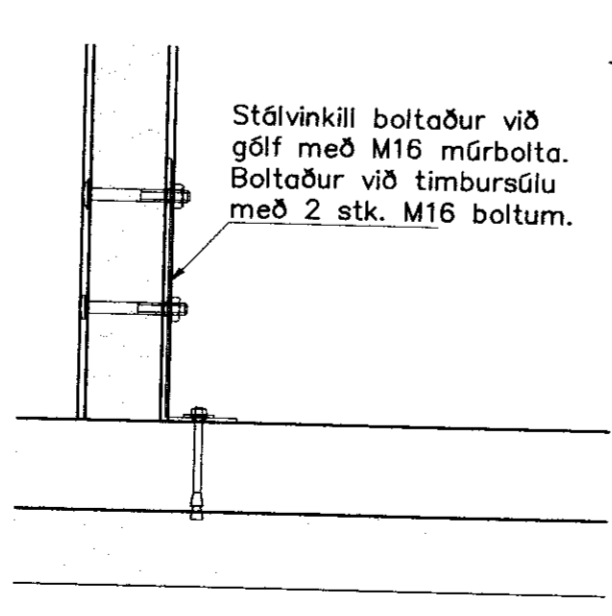

D7 Deili 1:10

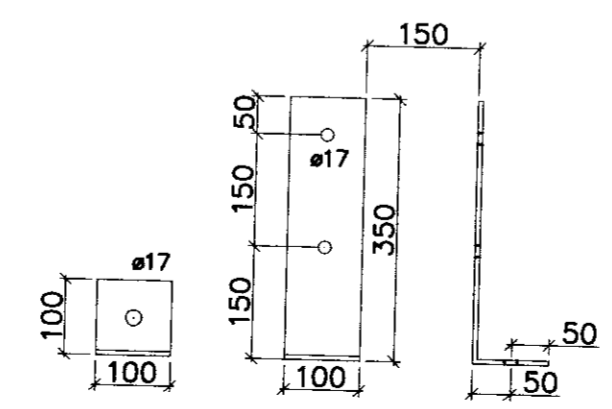

VERKFRÆÐIÞJÓNUSTAN EHF
SKEIFAN 19 • 108 REYKJAVÍK • Sími: 517 9050 • Netfang: teknik@teknik.is

<p>Hrauntröð 25 Grimsnes- og Grafingshreppur</p>	<p>Staðsetning: Burdarþol Veggir og þakplan Sníð og deili</p>	<p>Staðsetning: Svavar M. Stigurjónsson</p>	<p>Staðsetning: Svavar M. Stigurjónsson</p>	<p>Staðsetning: Svavar M. Stigurjónsson</p>	<p>Staðsetning: Svavar M. Stigurjónsson</p>
<p>SMR: SMS</p>	<p>TEKNIKI: SMS</p>	<p>MÁLI: GH</p>	<p>FRÁBYGGINGAR: GH</p>	<p>STAF: 213</p>	<p>STAF: 213</p>

Q:\verkefni\11\11-17 Hrauntröð 25\Teikningar\B-teikn\211 Hrauntröð 25.dwg