

Suð-austur hlið; 1:50

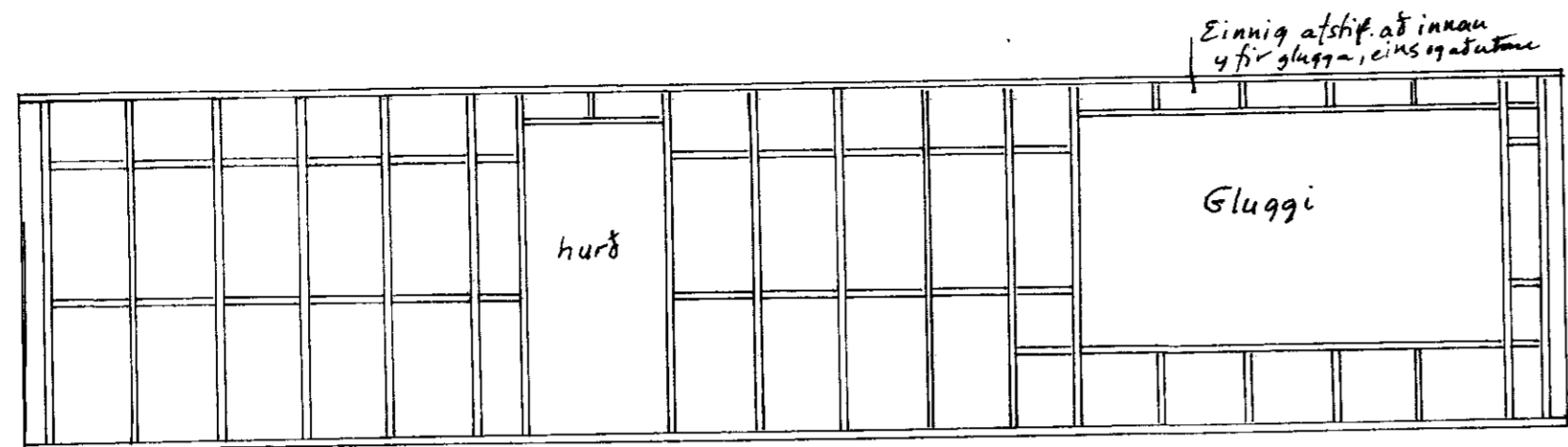

Norð-vestur hlið; 1:50

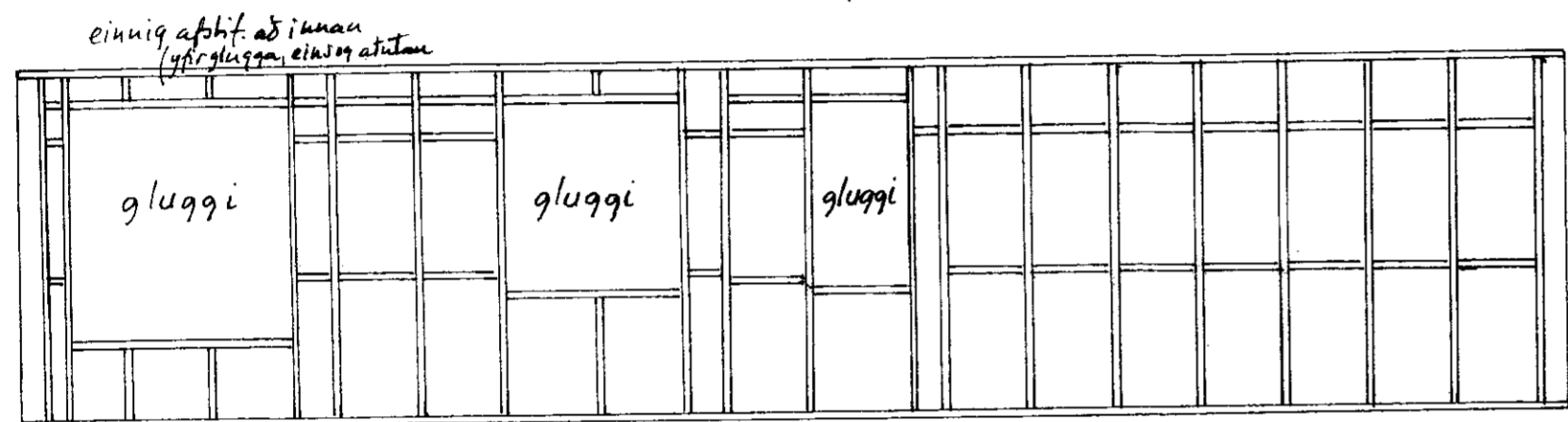

Suð-vestur gafi; 1:50

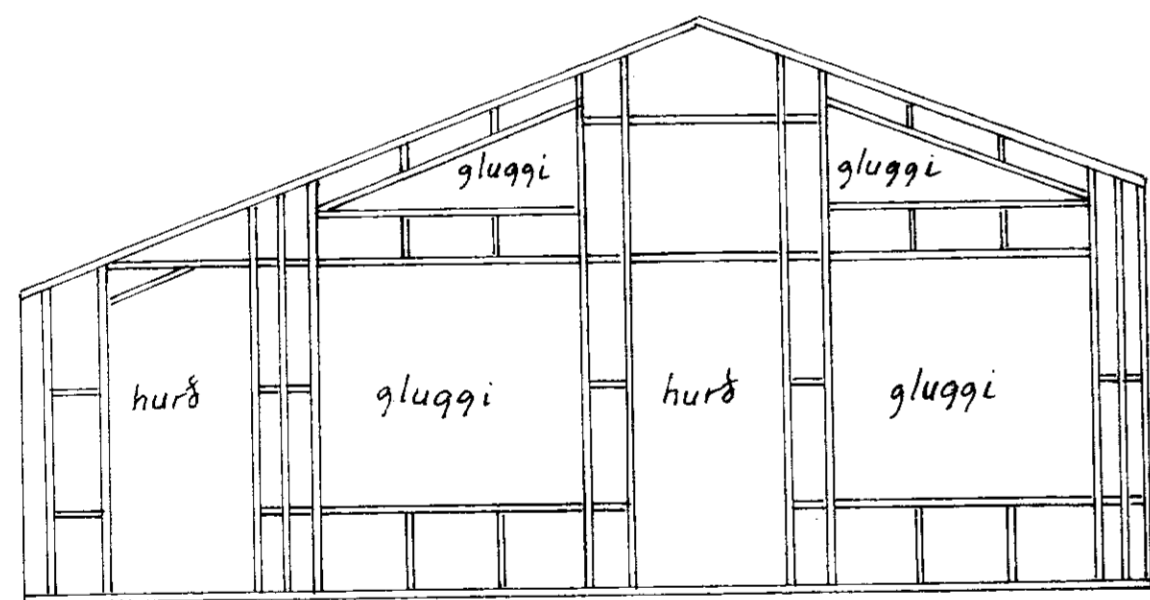

Norð-austur gafi; 1:50

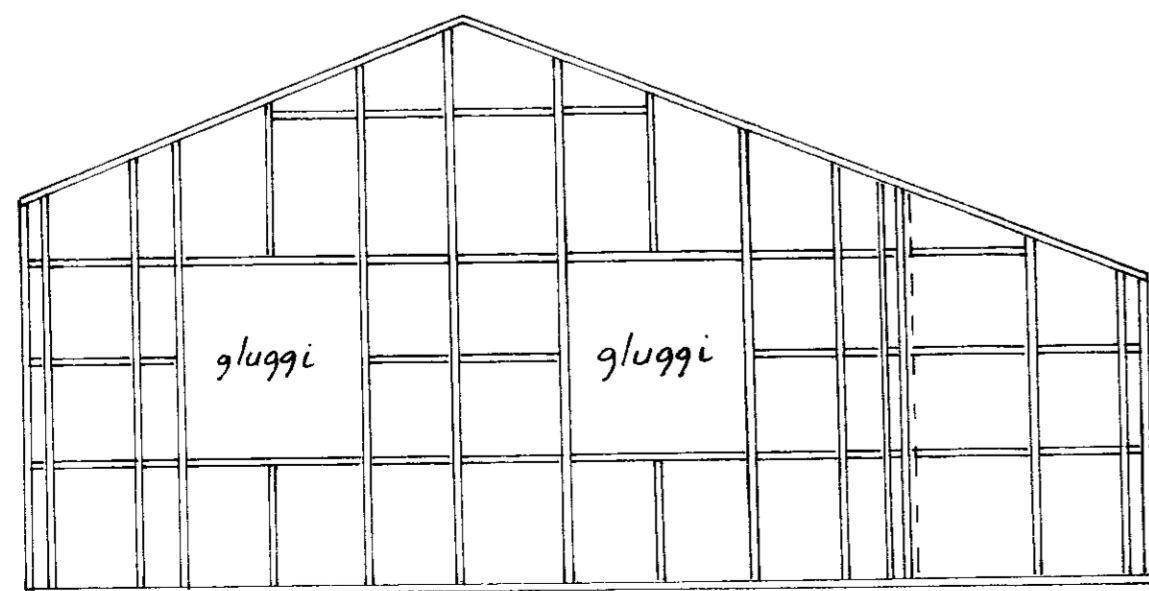

Grunnmynd sperra, 1:50

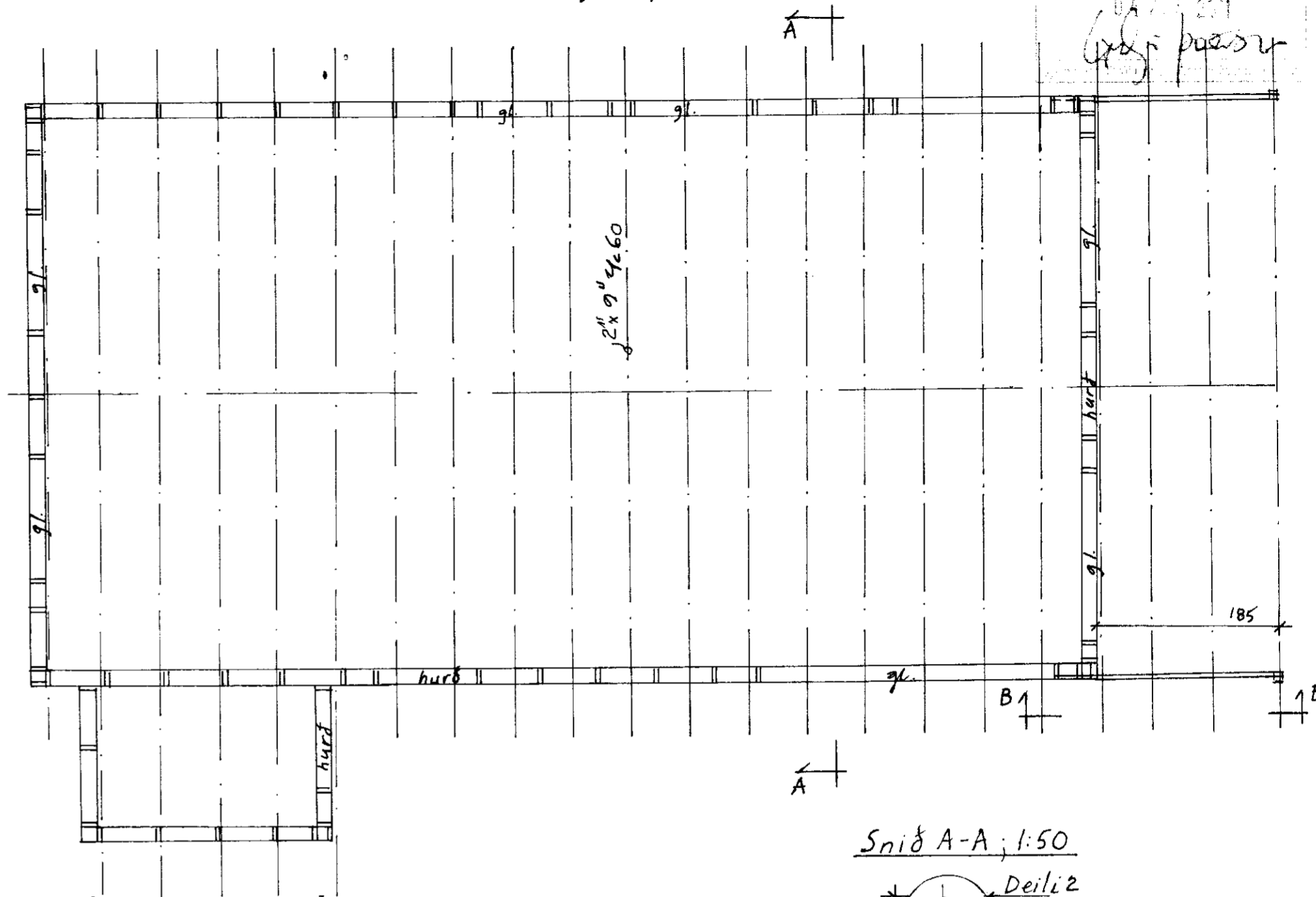

Snið A-A; 1:50

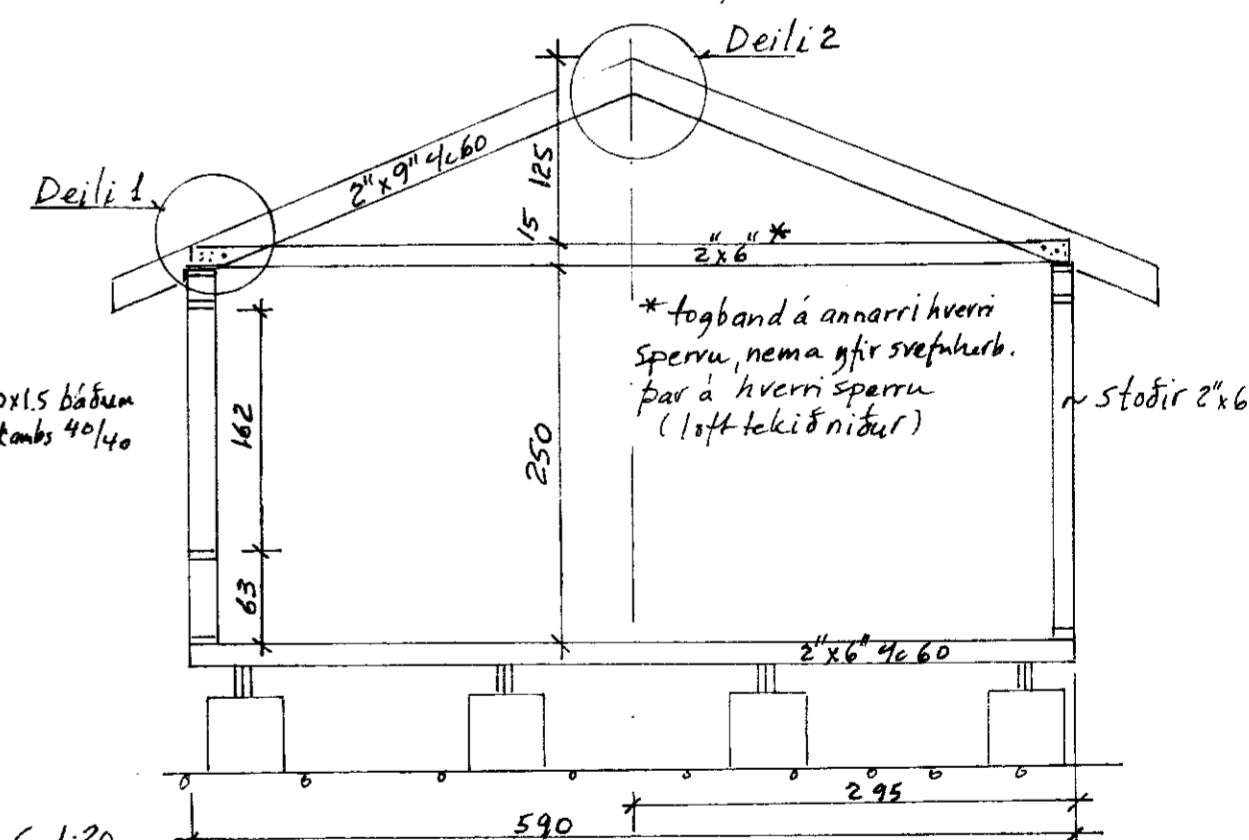

Deili 1; 1:20

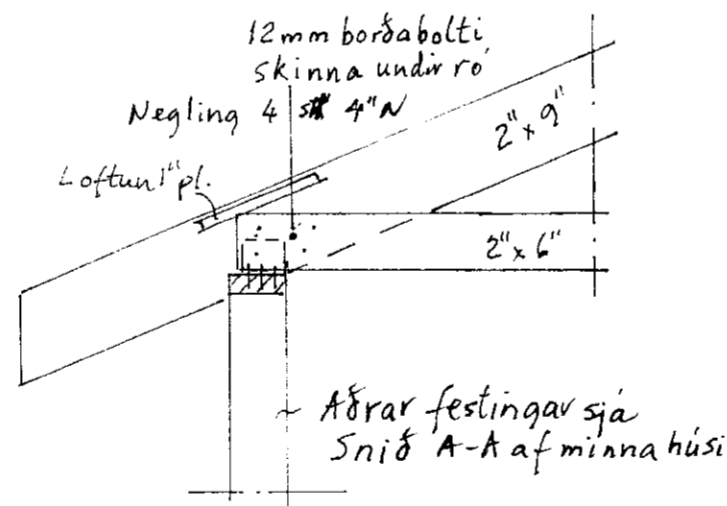

Deili 2; 1:20

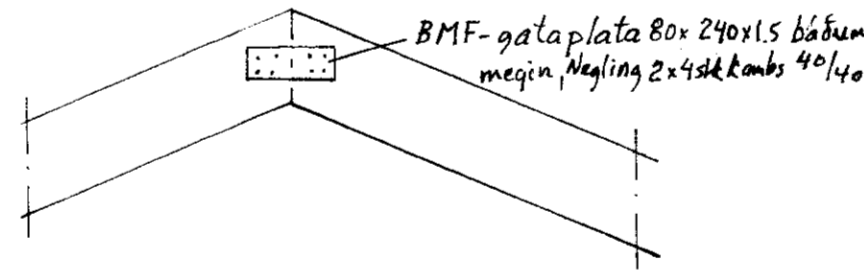

Snið B-B; 1:20

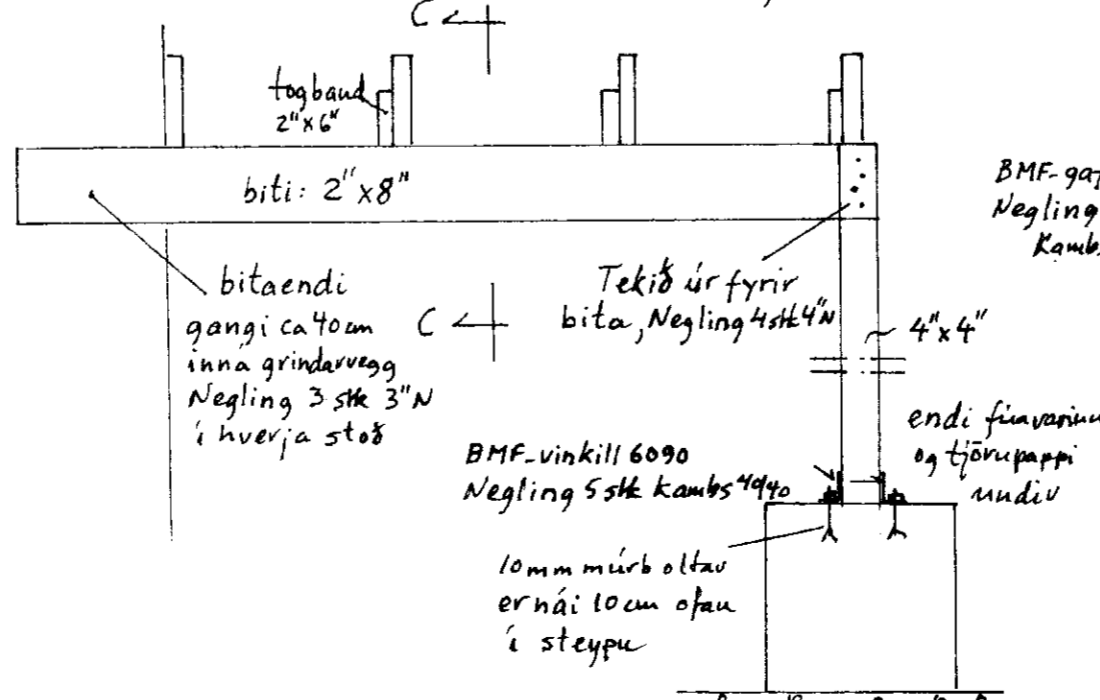

Snið C-C; 1:20

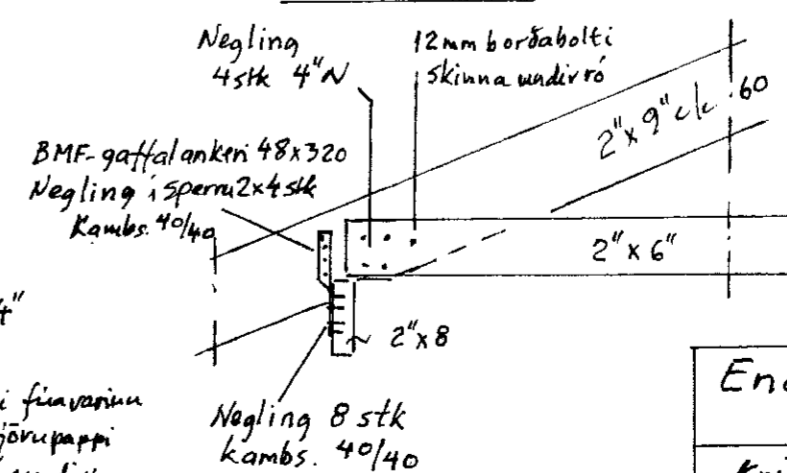

SKÝRINGAR:
 Allt grindar- og sperruefni skal vera T1 (DK 18) þak skal heilklaðt með 1" x 6"
 Afstífing veggja:
 Húsið skal klætt að utan með 9mm grenikrossvið
 Sem skal þéttneglður í polyuretán útilim.
 Negling kambasaur 31/40 c/c 15cm í stoðir og lausholt. Yfir stærstu gluggunum skal klætt með krossvið að innanverðu, sjá teikningu.

Engjavegur 1 í landi Álfstaða, Skeiðum, landnr. 195713

Kristján Þ. Haraldsson, verkfr. 58941107
 kt 070843-2699

MKV.
 1:50
 1:20

Teiknað
 Marg 2011
 Haraldsson

Blað 2/4