

MÖTTEKIÐ
17 DES 2012
Byggingafulltrúi uppáv. Arnessýslu og Fíðah. *[Signature]*

SNIÐ I-I (aðalhús)
sperrur við útv.

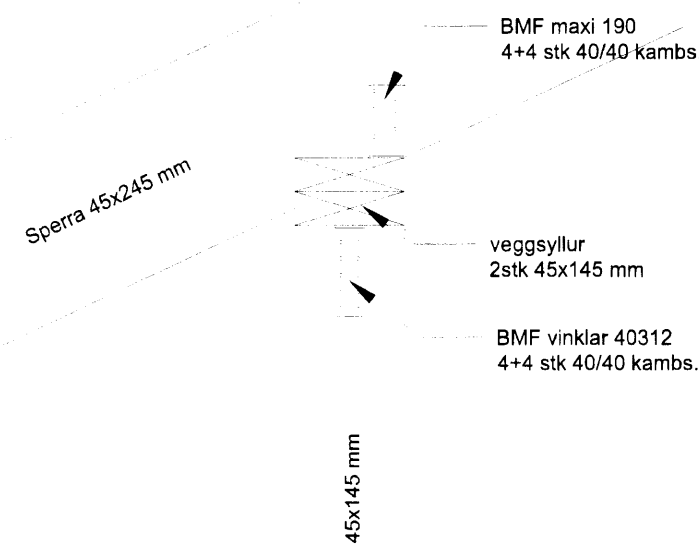

SNIÐ J-J (aðalhús)
sperrur og milliveggur við mæni

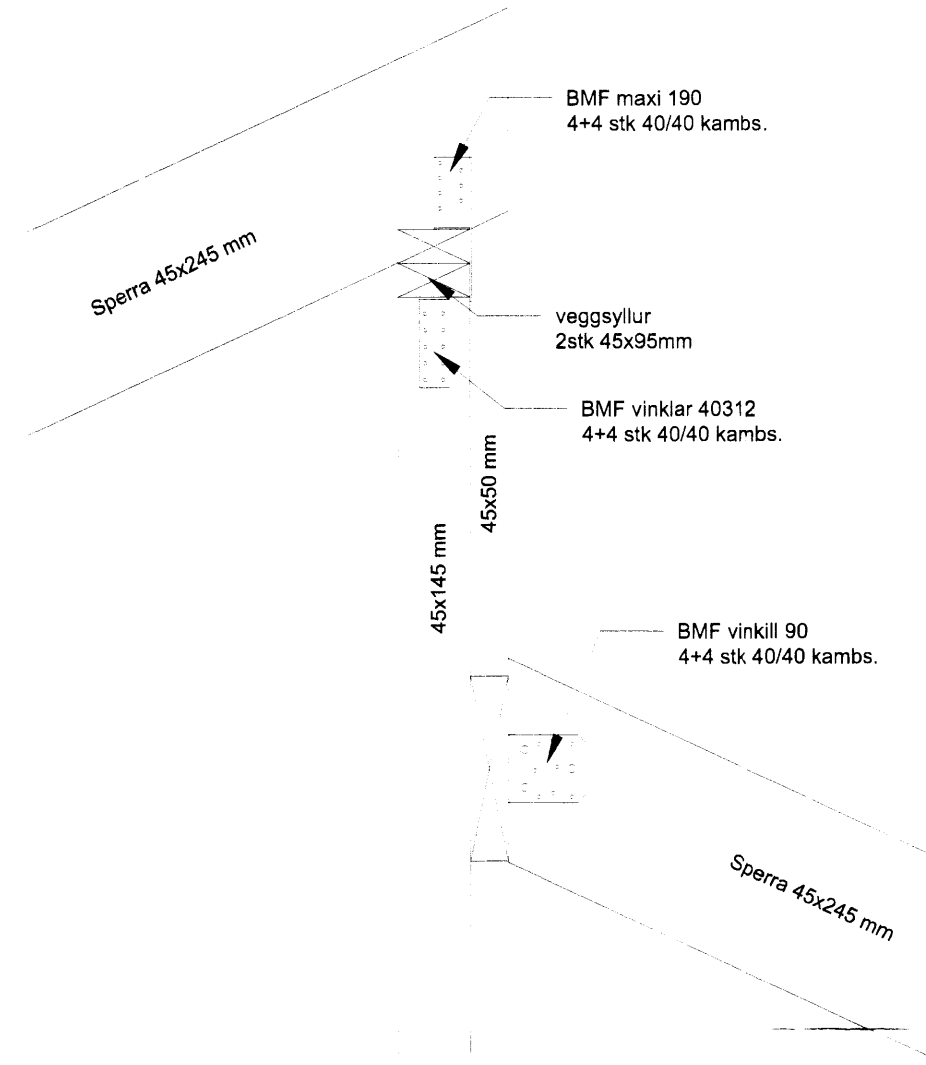

SNIÐ M-M (gestahús)
sperrur við útv.

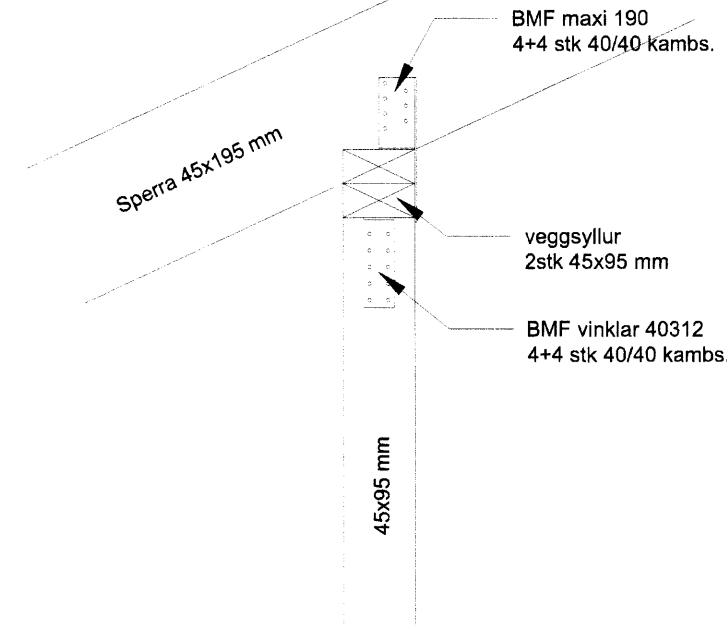

SNIÐ N-N (gestahús)
sperrur á burðarvegg í mæni

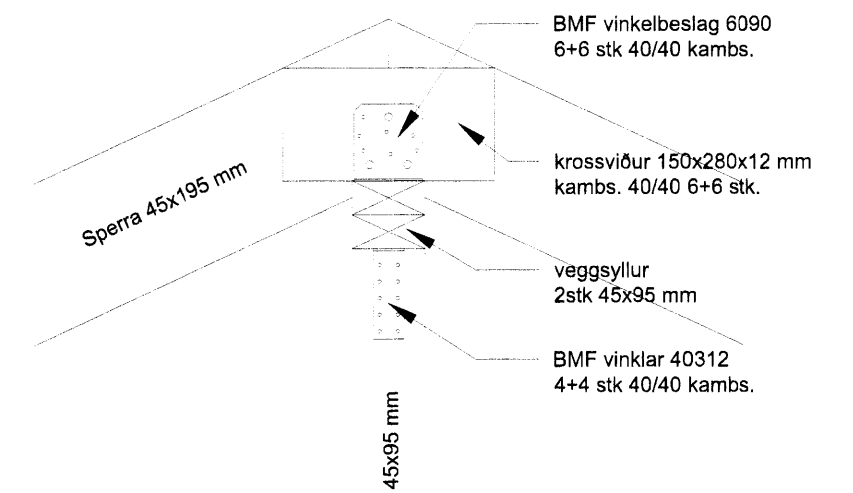

SNIÐ O-O (gestahús)
sperrur og biti í mæni

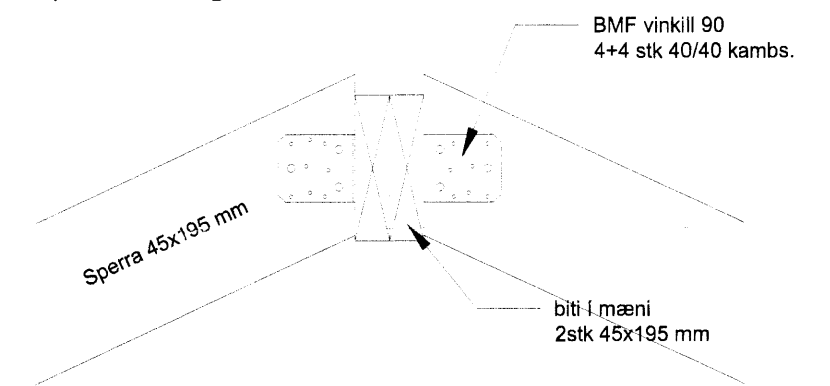

SNIÐ K-K (aðalh.)
stoðir við sökkulreim

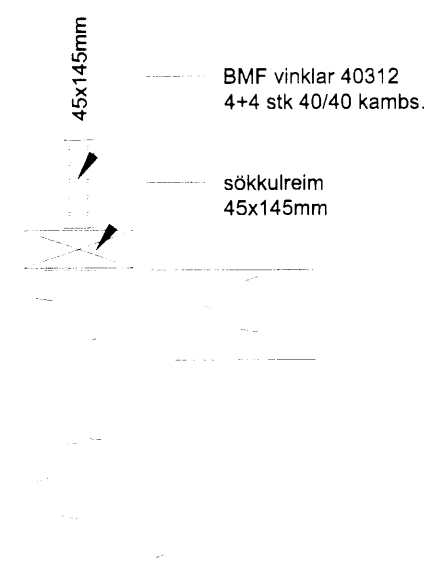

SNIÐ L-L (aðalh.)
stoðir milli stofuglugga

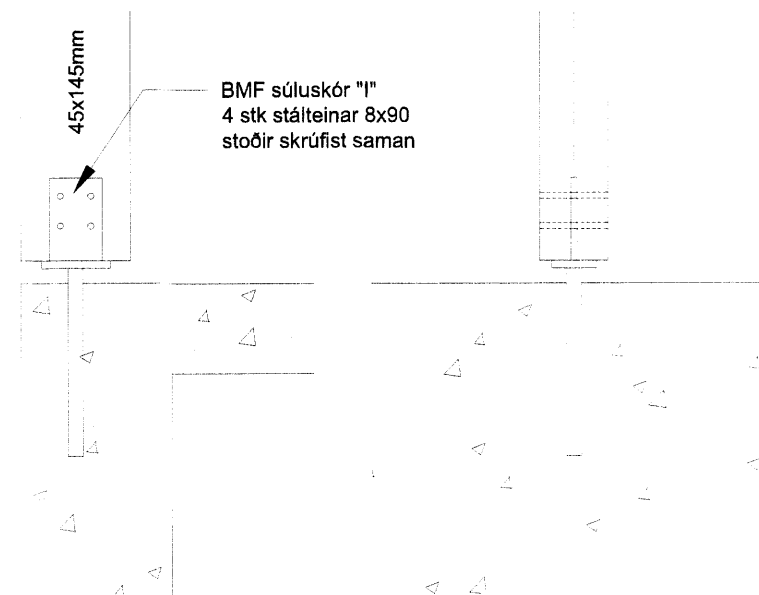

SNIÐ P-P (gestah.)
stoðir við sökkulreim

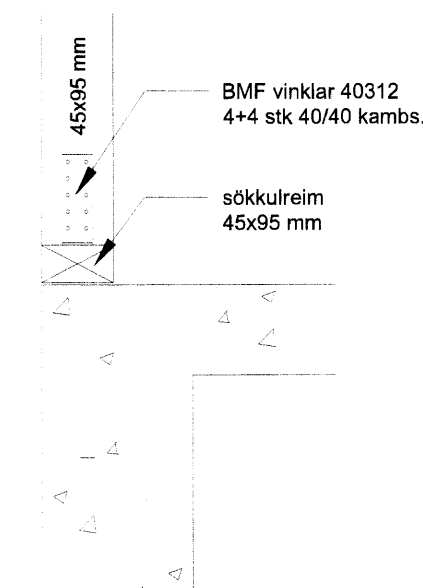

SKÝRINGAR:

Þaksperrur og veggjagrindur eru í gæðaflokki T1
Allur saumur og tengi er galvanhúðað